



THIS DRAWING IS A PRIVATE AND CONFIDENTIAL COMMUNICATION AND THE PROPERTY OF MANIRAMKA AND ASSOCIATES AND MUST NOT BE COPIED OR LENT WITHOUT THE CONSENT OF MANIRAMKA AND ASSOCIATES.

NOTES:
FOR SPECIFICATIONS AND DOOR & WINDOW SCHEDULE REFER DRG NO. 25N.S.ROAD/SD/01 AND 25 N.S.ROAD/SD/02 RESPECTIVELY

DECLARATION

CERTIFICATE OF ARCHITECT

I CERTIFY WITH FULL RESPONSIBILITY THAT THE BUILDING PLAN HAS BEEN DRAWN AS PER PROVISION OF K.M.C. BUILDING RULES 2009 AS AMENDED FROM TIME TO TIME AND THE SITE CONDITION INCLUDING WIDTH OF THE ABUTTING ROAD (31.268 MT.) CONFORMS WITH THE PLAN, WHICH HAS BEEN MEASURED & VERIFIED BY ME. IT IS A BUILT ABLE SITE NOT A TANK OR FILLED UP TANK. THE LAND IS DEMARCATED BY BOUNDARY WALL. EXISTING STRUCTURE SHALL BE DEMOLISHED BEFORE COMMENCEMENT OF THE CONSTRUCTION WHICH IS FULLY OCCUPIED BY THE OWNER & TENANTS.

Smit Manirama

SUNIT MANIRAMKA (B. Arch.)
Consulting Architect
Council of Architecture (Reg. No. CA/195/1999)

SIG. OF ARCHITECT

CERTIFICATE OF STRUCTURAL ENGINEER

THE STRUCTURAL DESIGN & DRAWING OF THE BOTH FOUNDATION AND SUPER STRUCTURE OF THE BUILDING HAS BEEN MADE BY ME CONSIDERING ALL THE POSSIBLE LOADS INCLUDING SEISMIC LOAD AS PER THE NATIONAL BUILDING CODE OF INDIA AND CERTIFY THAT IT IS SAFE STABLE IN ALL RESPECT. SOIL TESTING REPORT HAS BEEN DONE BY SKM GEOSURVEY, BK-130, SALT LAKE, KOLKATA-700091. THE RECOMMENDATION OF REPORT HAS BEEN CONSIDERED DURING STRUCTURAL CALCULATION.

SANJIV J. FAREKH
M.E. (STRUCT.), M.E. (CONSTR. ENG.)
B.C.E. (P.B.#1825-4)
E.S.E. No. 184 (1) K.M.C.

SIG. OF STR. ENGINEER

CERTIFICATE OF STRUCTURAL REVIEWER

THIS IS TO CERTIFY THAT I HAVE REVIEWED THE STRUCTURAL DESIGN OF PROPOSED PREMISES CONSIDERING ALL POSSIBLE LOADS INCLUDING SEISMIC LOAD AS PER PROVISION OF RELEVANT IS CODE AND IT IS ALSO CERTIFIED THAT THE BUILDING IS SAFE AND STABLE IN ALL RESPECT.

SANJIB GUHA
B.Sc. (CIVIL), M.E. (115884-5)
CHARTERED ENGINEER
ENLISTED STRUCTURAL
REVIEWER 88/16 K.M.C.

SIG. OF STR. REVIEWER

CERTIFICATE OF THE GEO-TECHNICAL ENGINEER

IT IS CERTIFIED THAT THE COMPREHENSIVE GEO-TECHNICAL REPORT ON SOIL INVESTIGATION HAS BEEN PREPARED BY ME FOR DESIGN AND CALCULATION OF THE FOUNDATION BY ANALYZING THE SOIL SAMPLE FOR ESTIMATING THE BEARING CAPACITY OF THE SOIL ON WHICH FOUNDATION OF THE STRUCTURE WILL BE CONSTRUCTED. I SHALL ALSO CHECK THE NATURE OF THE SOIL AFTER EXCAVATION AT SITE SO THAT FOUNDATION IS EXTENDED UP TO APPROPRIATE DEPTH THAT HAS BEEN PROPOSED IN THE GEO-TECHNICAL REPORT.

JISHNU PAL
B.Tech. (CIVIL), M.E. (109-1001)
K.M.C. Reg. No. 01/11/32
G.T.E.R./KMDA/10/0043
22/10/2009 (C-1/2016-17
H.M.C. Reg. No. 8078/CLASS-1/15

SIG. OF GEO-TECHNICAL ENGINEER

CERTIFICATE OF OWNER

WE DO HEREBY UNDERTAKE WITH FULL RESPONSIBILITY THAT -
1) WE SHALL ENGAGE L.B.A. & E.S.E. DURING CONSTRUCTION;
2) WE SHALL FOLLOW THE INSTRUCTION OF L.B.A. & E.S.E. DURING CONSTRUCTION OF THE BUILDING (AS PER B.S.PLAN)
3) K.M.C. AUTHORITY WILL NOT BE RESPONSIBLE FOR STRUCTURAL STABILITY OF THE BUILDING & ADJOINING STRUCTURE.
4) IF ANY SUBMITTED DOCUMENTS ARE FOUND TO BE FAKE, THE K.M.C. AUTHORITY WILL REVOKE THE SANCTION PLAN.
5) THE CONSTRUCTION OF WATER RESERVOIR AND SEPTIC TANK WILL BE UNDER THE GUIDANCE OF L.B.A. / E.S.E. BEFORE STARTING OF BUILDING FOUNDATION WORK.

For Bengal Bonded Warehouse Limited
Director

SIG. OF OWNER

PLAN OF PROPOSED G+32 (127.200 MT HT.) STORIED 'MEGA COMMERCIAL PROJECT' AT PREMISES NO: 25, NETAJI SUBHAS ROAD, WARD NO - 45, BOROUGH - V, P.S. - HARE STREET, KOLKATA - 700001 KOLKATA MUNICIPAL CORPORATION, AS PER SECTION 412A OF KOLKATA MUNICIPAL CORPORATION ACT 1980

SANCTION DRAWING

12TH TO 28TH FLOOR PLAN AND 29TH TO 32ND FLOOR PLAN (SOUTH TOWER)

STRUCTURAL ENGINEER :
SPA CONSULTANTS (SPA)
34 RAMMOHAN DUTTA ROAD, KOLKATA-700020
WEST BENGAL, INDIA
Email: spa_cons@yahoo.co.in

DATE: 20.07.2023 SCALE: 1:100 DEALT: MAHUA/ RUCHIRA DRG-NO-25 N.S.ROAD/SD/18

ARCHITECTS :
MANIRAMKA AND ASSOCIATES
74 B, A. J. C. BOSE ROAD, KOLKATA-700 016
PHONE : (033) 2217 8329
Email: maniramka.associates@gmail.com
www.maniramkaarchitect.com

SHEET =
18 OF 26

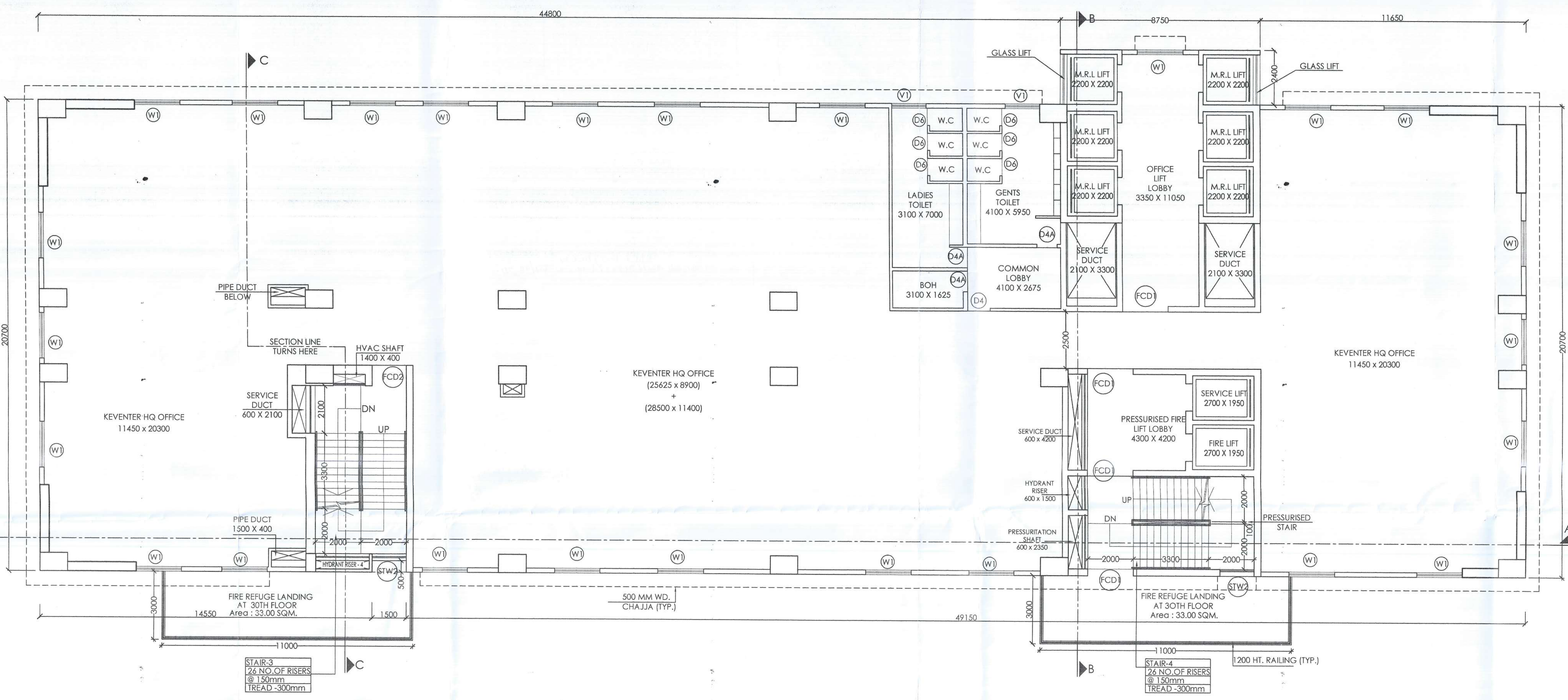

29TH,30TH,31ST & 32ND FLOOR PLAN (SOUTH TOWER)

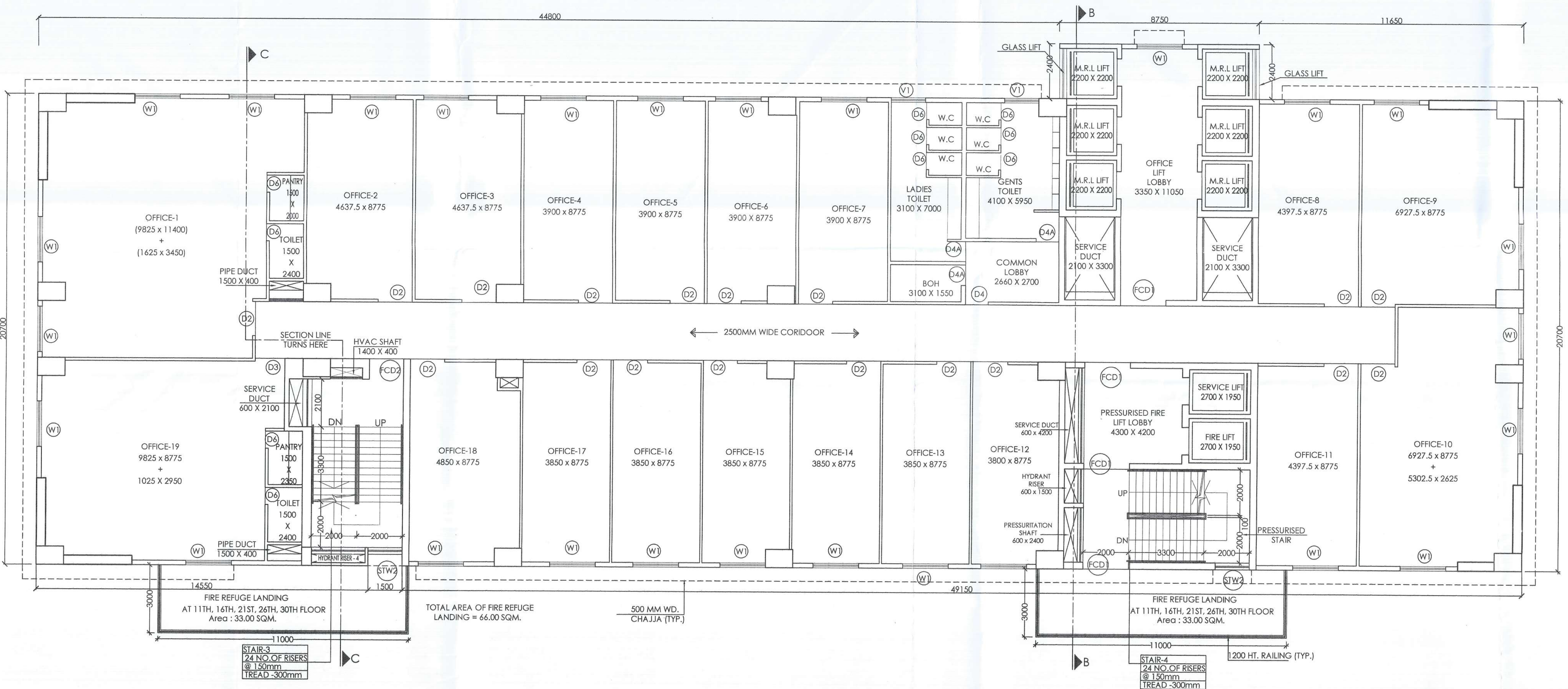

12TH TO 28TH FLOOR PLAN (SOUTH TOWER)

SOUTH TOWER

PARTY'S COPY

Plan for Water Supply arrangement including SEMLI G & O. H. reservoirs should be submitted at the Office of the E-Engineer Water Supply and the sanction obtained before proceeding with the work of Water Supply. Any omission may lead to disconnection/penalisation.

Before starting any construction the site must conform with the same sanctioned and the conditions as proposed in the plan should be fulfilled.

The validity of the written permission to execute the work is subject to the above conditions.

The sanction refers to the proposed portion shown in red and the Engineers makes no admission as to the correctness of the plan.



Design of all Structural Members including that of the foundation should conform to standards specified in the National Building Code of India.

CONSTRUCTION SITE SHALL BE MAINTAINED TO PREVENT MOSQUITO BREEDING AS REQUIRED URS 498 (1) & (2) OF CMC ACT 1960. IN SUCH MANNER SO THAT ALL WATER COLLECTION & PARTICULARLY LIFT WELLS, VENTS, BASEMENT CURING SITES, OPEN RECEPTACLES ETC. MUST BE EMPTIED COMPLETELY TWICE A WEEK.

The building materials that will be stacked on Road/passage or foot-path beyond 3-meters after construction of G Floor whichever is earlier may be seized forthwith by the K.M.C. at the cost and risk of the owner.

No rain water pipe should be fixed or discharged on road or footpath. Drainage plan should be submitted at the Building Executive Engineer's Office and the sanction obtained before proceeding with the drainage work.

A suitable pump has to be provided for pumping untreated water for the distribution to the lifting elevators and tanks in the building. Incess untreated water from street main is not available.

Non-Compliance of Electricity Regulations within three year will require fresh application for sanction.

BUSINESS BUILDING
THE SANCTION IS VALID UP TO 20-07-2023

RENOVATION WORK MEANS DEMOLITION
Necessary steps should be taken for the safety of the lives of the adjoining public and private properties during construction.

Approved By: *M.P.C. Wani* 67
For: *M.P.C. Wani* 67
The Building Committee
Date: 21/07/2023
Contract No. 79/23-24

